

LOOKING FOR A BETTER WAY TO COVER THE JOINTS ?



PROFILLER™



Crack Filler

Crack Filler for Finishing Joints

THE RIGHT FILLER FOR EVERY JOINT

ProFiller™ jointing products have been developed to give you the best results when bedding tapes, corner beads and finishing joints.



PROFILLER™ Crack Filler Dry-Mix



PROFILLER™ Crack Filler Ready-Mix



ARISH jointing products give you the smoothest finish!

PROFILLER™

GYPSUM BASED CRACK FILLER FOR GYPSUM BOARDS JOINTS AND BOARD SKIMMING

ProFiller™ is a powdered base compound which is specially formulated plaster to be used for jointing gypsum boards, hiding screw/nail heads, repairing cracks and also can be used for lining surface before final painting. It gives a fine and smooth finish, as well as an easy application and sanding.

ProFiller™ is a dry-mix compound which comes in setting 60 minutes which requires only clean water to be added to prepare it for use.

Features

- Gives Fine And Smooth Finish Surface.
- Easy To Mix And Apply.
- High Crack Resistance.
- Low Shrinkage.
- Excellent Tape Bonding strength.



Mixing

The powder should be added gradually to clean water in a clean mixing vessel, stirring continuously until a smooth creamy consistency is achieved. Excessive mechanical mixing should be avoided and only low-speed mixers used. Once the material starts to set it must be used quickly or discarded, it cannot be remixed. Contamination from previous mixes can shorten the setting time and reduce the strength of the product.

***Note Well:** ProFiller is not to be mixed with other products. ProFiller is to be used only in interior

Application Instructions:

Apply ARISH ProFiller to the joint to embed the tape and immediately overcoat to fully fill the tapered board edges and just feather out onto the board surface. Allow to set – min 140 minutes – before applying the finishing coat.

1st coat



Apply ProFiller 150mm wide and joint reinforcement.

2nd coat



Apply an even coat of ProFiller, 200mm wide.

3rd coat



Apply an even coat of ProFiller, 275mm wide.

PRODUCT SPECIFICATIONS	PROFILLER™ CRACK FILLER DRY-MIX
WORKING TIME	60 minutes (depends on local conditions)
WATER RATIO	13 LTR in 20 Kgs bag (650 ML in 1 Kgs)
APPROXIMATE COVERAGE	2.6 Sq.m/ Kg
CONTAINED VOLUME	20 Kg/ bag
STORAGE METHOD	Keep in an elevated position in dry place without high humidity condition and direct exposure to heat or sunlight.
PRODUCTS SHELF LIFE	6 Months



Storage:

Bags should be stored dry, as absorption of water shortens the setting time, causes set lumps to form in the bags and may reduce the strength of the set product.

If storing on a concrete floor, dry timber platforms should be provided. ARISH ProFiller stored correctly has a shelf life of 6 months.

PROFILLER™ READY-MIXED

CRACK FILLER READY-MIXED BUCKET FOR SKIMMING & FINISHING JOINTS

ProFiller™ Ready Mixed crack filler is a liquid based compound which is specially formulated for finishing Gypsum Board walls and ceilings joints hiding screw/nail heads, repairing cracks and also can be used for skimming surface before final painting. It is a pre mixed compound which can be applied from the bucket without mixing or using additional water.

ProFiller Ready mixed is suitable for commercial, residential and industrial use. In addition to Gypsum Board, it is also designed to repair and touch up various other kinds of interior surfaces both old and new prior to painting.

Features

- Excellent Tape Bonding strength.
- Easy To Sand.
- Ready To Use And Save Time.
- Long Working Time
- Multipurpose Applications
- Gives Fine And Smooth finish surface.
- Minimal Shrinkage
- Extremely Durable



Application Instructions:

- Ensure surface is clean, dry, sound and free from dust dirt and foreign matter.
- Fix self adhesive fiberglass tape to gypsum board joints.
- Apply Gypsum ProFiller Ready Mix in a thin, even layer and allow to dry. Two coats may be necessary for leveling.
- Light sand the dry, final surface before painting, preferable within 24 hours of application.



PRODUCT SPECIFICATIONS	PROFILLER™ CRACK FILLER READY-MIXED
TIME BETWEEN COATS	12 -24 hours (depends on the Local condition)
STANDARDS	Complies with ASTM C475 & ASTM C840
AVERAGE CONSUMPTION	1.75 kg/m2 /mm thickness depending on substrate conditions
SANDING	Use a very fine 150 – 160 grit sandpaper
CONTAINED VOLUME	25 Kg
TOXICITY	Non-Toxic
DENSITY	1.75 Kg/ Lt
STORAGE METHOD	Keep in a dry place without high humidity condition and direct exposure to heat or sunlight. Part used buckets should be sealed tight between applications.

*Precautions:

*ProFiller™ is to be used for internal applications only. Sanding dust from dry sanding may cause eye, nose, throat or respiratory irritation.

Long term breathing of particles may cause lung diseases. The use safety glasses and an approved dust mask is recommended.

***Warnings:** ProFiller™ Ready Mixed is not to be mixed with other products. When sanding ProFiller™ a mask should be used. ProFiller™ is to be used for internal applications only.

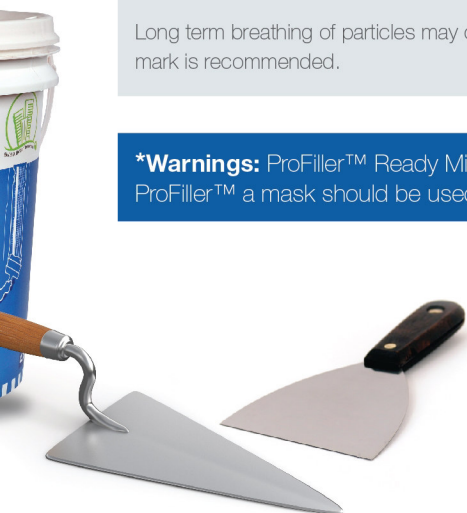



HEAD OFFICE

Suite # 105, Business & Finance Centre,
I.I Chundrigar Road, Karachi, Pakistan.
UAN: +92-21-111-332-497
T: +92-21-3243 4308, 3241 3832, 3246 7890
F: +92-21-3242 3721
E: info@arishdrywall.com

REGIONAL OFFICE

Suite # 519, 5th Floor, Silver Oaks F10,
Islamabad, Pakistan.
Tel: +92 301 873 4684

WWW.ARISHDRYWALL.COM
www.facebook.com/Arishdrywall

A PRODUCT OF
LODHIA
G Y P S U M
ISO 9001 : 2008



PROFILLER™

"Arish", ProFiller is the Registered Trademark of Lodhia Gypsum Industries (Pvt) Ltd.
© Lodhia Gypsum Industries - All Rights Reserved