

LOOKING FOR
A BETTER WAY TO
PLASTER WALLS
AND CEILINGS?



A REVOLUTIONARY PRODUCT!

PROPLASTER™



Smooth as Silk
Light Weight Gypsum Wall Plaster

THE RIGHT PLASTER FOR EVERY SURFACE

Application thickness from 8mm - 25mm

- Reduce Energy Consumption
- Fire Resistant

TURNING 28 DAYS INTO 48 HOURS!

CHANGE YOUR VIEW ON BUILDING TIMELINES WITH PROPLASTER™



ARISH™ ProBoard™ range are manufactured for life and are designed to achieve optimal performance.

PRO SERIES PLASTER SYSTEM

High Quality Light Weight Gypsum Plaster

ProPlaster™ manufactured from the highest quality gypsum. Our Pro Series of Plaster are designed for any type of interior wall and ceiling surfaces, providing non-combustibility, directly over porous concrete blocks.

PROPLASTER™



- Sand & Cement not required
- One Coat of Putty Application

PROPLASTER™ FINISH COAT



- Gypsum Plaster Putty
- High Coverage



Think Green! Its 97% Gypsum content makes it environmentally friendly!

WHAT IS GYPSUM PLASTER ?

Gypsum Plaster is produced by controlling some critical calcinations parameter which is essential to master the growth of the plaster crystals. Gypsum selection and preparation (cleaning, classifying) are key factors to produce the best plasters, and the performance of the plaster depends a lot on its crystals' sizes and shapes.

Gypsum plaster is not a modern invention like Portland cement, as some people might suggest. We know that it was used by the ancient Egyptians to plaster the pyramid at Cheops. Gypsum Plaster is a material superior to other alternatives for the internal plastering of all structure, this system replaces sand and cement master.

PRIMARY USE :

All commercial and residential buildings such as:

- Theatres
- Hotels
- Shopping centres
- Industrial factories
- Houses.



PERFORMANCE OF GYPSUM DRIVERS:

DIRECT APPLICATION:	Direct application on most internal backgrounds including brick, block and concrete walls.
CRACK FREE:	Free of shrinkage cracks, as gypsum does not shrink or expand once settled.
HIGH STRENGTH:	Gypsum plaster is essentially reconstituted rock and exceptionally hard.
NO CURING:	Requires no water curing.
LIGHT WEIGHT:	Density being less, weight of finished product is much lighter which leads to high coverage, and less transportation cost.
HIGH PRODUCTIVITY:	Additives impart high coverage resulting in more work in less time and low wastage.
TIME SAVING:	Results in substantial time saving as compared to conventional plastering methods.
READY TO USE:	Easy to apply imparting better cohesiveness and adhesion.
FIRE PROTECTION:	A wall plastered with conventional gypsum plaster is non-combustible when tested in accordance with BS 476: Part 4: 1970.
HIGH THERMAL INSULATION:	R = 0.07 m ² K/W at 13 mm thickness.
SOUND INSULATION:	The finished plaster wall is denser than a typical wall finished as a result it has a greater resistance to the passage of sound. Insulation ratio up to 55dB at 120mm partition wall system.
VERMIN PROTECTION:	The monolithic surface of gypsum plaster from floor to ceiling is a very effective barrier to insects, rodents and any other vermin.
AIR BARRIER CHARACTERISTICS:	Because of its monolithic nature, conventional gypsum plaster provides added value in keeping out cold winter drafts. This affords the occupants a warmer more comfortable home.
LOW THERMAL CONDUCTIVITY:	Gypsum's inherent nature helps in energy conservation.

PROPLASTER™

WHAT IS PROPLASTER™?

Arish™, ProPlaster™ is gypsum based plaster is suitable for application on most internal backgrounds including brick, block and concrete. It consists of Gypsum Hemihydrate, formulated with special additives to enhance working and setting characteristics. It is specially formulated to replace a dirty, time consuming and conventional (sand-cement) plastering methods of interior walls. It contains light weight aggregates to improve plaster's workability, coverage, application and post usage behavior.

ProPlaster™ is the products of an advanced technology which has attained the much-desired excellence under strict quality control system which comes in two types of Plasters;

PROPLASTER™

ProPlaster™ One Coat Plasters technology eliminates the need for a two coat plastering system plastering and putty application, and provides a tough and durable smooth, silky white surface ready to receive a decorative finish. It replaces a dirty and conventional masonry (sand-cement) plastering and relatively easy to work with.

QUALITIES:

- One coat application.
- Leveling and finishing plaster for brick and block surfaces.
- Surface can be painted directly after dry out without the need of putty.



One Coat and Base Coat plaster can be applied from 8mm to 25mm thick which can be either machine or hand applied, making ideal for any size of commercial or domestic applications. However, when machine applied it offers excellent productivity and is up to 3 times faster than traditional plastering methods.

[See page No.12](#)

PROPLASTER™

FINISH COAT

ProPlaster™ Finish Coat is a gypsum based putty formulated for application over Base Coat and One Coat Plaster. It is recommended for interior wall and ceiling surfaces, and over properly prepared monolithic concrete in residential and commercial projects. It provides a strong, hard surface that resists abrasion and surface cracking, creates a beautiful white finish and offers a fire rating of up to four hours.

QUALITIES:

- Harder than regular gauging and lime putty finish.
- Fast-applying—permits next day decorating
- Excellent coverage



PLASTER AND PAINT FASTER

WHY PROPLASTER™ PLASTERING SYSTEM

Paint can be applied directly to plastered surfaces without the need for a primer within 48 hours of application. It is suitable for application to brickwork, block work, and concrete surfaces. It is non-corrosive to metal, wood and glass. It is fire resistant up to 30 minutes if applied to a 10mm thickness.

ADVANTAGES OF PROPLASTER PLASTERING SYSTEM:

- Saves substantial time
- Creates a smoother finish
- Decreases Energy Consumption
- Uses 58% less water than with sand and cement
- No need of sand and cement, completely clean site
- Reduces echoes and level of noise
- Requires less paint
- Salt resistant.

SMOOTHNESS
BEYOND
IMAGINATION



MIXING INSTRUCTIONS

- Use clean water and clean container (not a dry drum or wheelbarrow)
- Add ProPlaster to water, measure out 15 liters of clean water in a 30 kgs bag and soak for 10 minutes.
- Mix slowly if manually, do not mix with your hands, if using drill machine turn on the drill when the plaster is wet. Mix for 5 minutes and keep 800RPM, mixture must have texture of thick cream. Do not over mix the plaster
- Mixing should preferably be done by mechanical means. This aerates the plaster, increasing coverage and improving workability.
- Mix only until the plaster is lump free. Do not re-stir or add more ProPlaster or water to the mix after mixing is complete.
- Do not mix more plaster than you can use in 80 minutes. (Not more than 2bags per mixing container)
- Do not add any foreign matter (e.g. cement or sand) to ProPlaster. Use it neat



***Note Well:** Water ratio is an approximate figure. Workability can be altered by adding or reducing the volume of water.



APPLICATION TIPS:

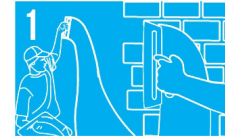

1 First Spray the water on wall surface and then apply ProPlaster onto wall surface.



2 Level it out with a Darby or straight edge. Leave until partially set. Test with the back of your hand – ProPlaster must stick to the wall, not your hand.



3 Right after the final setting, using the sponge to extract gypsum serum out of the plaster. Only use enough water to lubricate the trowel.

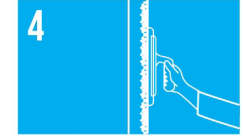

4 The rubber float will bring fat to the surface fast and help smooth the plaster.

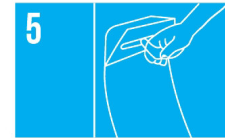

5 Using a steel trowel scrape the "fat" off the wall. Throw this "fat" away. it is dead plaster.

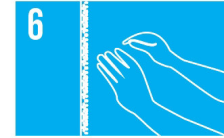

6 Before decoration check the entire surface carefully to see that the plaster has set hard, is dry and free from powder/dust.

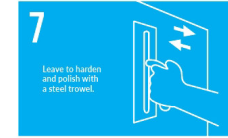

7 Leave to harden and polish with a steel trowel.



8 Clean utensils after each mix. Materials from a previous mix, scraped down from a darby or any other tool, must not be added to a fresh mix.

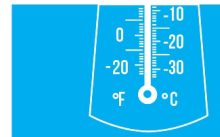

Do not apply ProPlaster while temperature is below freezing.

Ideal Temperature for application: | 5 - 45

ProPlaster™ Finish Coat is used as the final layer for the smooth finish on Base Coat. One bag of Finish Coat will cover 600sq ft. on Base Coat; for the extra smooth surface a thin layer of Finish Coat can also be applied on One Coat.

***Precautions:** ProPlaster should not be used in areas where walls are washed with hosepipes, in showers or in industrial type kitchens. Do not tempt to remix or over mix ProPlaster.

GYPSUM PLASTING TOOLS:

dekor.
Made in Turkey!



Elastic Bucket



Brick Trowel



Steel Trowel



Plaster Trowel



Rubber Float



Polishing Spatula



Putty Trowel



External Angle Trowel



Internal Angle Trowel



Plane for Corner



Tackel / Levelling Strip

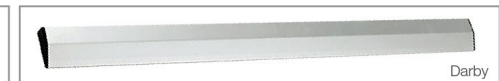

Darby

(Available in PAKISTAN)

CHANGE YOUR VIEW ON BUILDING TIMELINES



PROPLASTER™ SPRAY FINISH

It's Plaster, But Faster!

Generally speaking, when applied by hand, the plaster application is a labor intensive process. However, when applied by machine, the process becomes simpler and more efficient, allowing for continuous mixing and an increase in the productivity of the plastering team.

MIX IT | SPRAY IT | FINISH IT

- High productivity, 4times faster than current working speed
- 30% saving on Labour cost



MP 25 MIXIT
For application of ProPlaster™



German Technology

PROPLASTER™ SPRAY FINISH IS THE WAY FORWARD

Inimitable ProPlaster methodology developed by Lodhia Gypsum Industries is proven to be four times faster than conventional plaster. It aims to achieve labor efficiency, by offering Quality-assured material, ready to be applied through spray plastering machine, promising guaranteed results, leading to reduced man power & increased work efficiency.

IDEAL FOR RIGID DEADLINES AND BUDGET CONSTRAINTS

Arish™ ProPlaster™ Spray Finish light weight gypsum leveling plaster, which can be sprayed directly onto walls which is much faster, creates a smoother finish and reduces costs. Revolutionary in its results, it is set to save substantial time, labor and water costs especially on large building projects.



GET A PROPLASTER™ SPRAY FINISH YOU'LL BE PROUD OF, IN HALF THE TIME.

ProPlaster™ Spray Finish is a gypsum finishing plaster. For Use with worm pump spray machines, providing A smooth, high quality finish onto wall surface In a fraction of the time of traditional plastering methods

This improves productivity and enables projects to be handed over earlier.

“ SPRAY SOME PEARL SHINE
TO YOUR INTERIOR! ”



APPLICATION STEPS:



Step 1: Mix

ProSeries wall plasters are also designed to work with worm pump spray machines. Simply open the bag over the machine hopper and set the machine water gauge to 800 millibar and the machine automatically mixes the plaster to a consistent mix.



Step 2: Spray

Damp the wall surface first and Spray ProPlaster to an even thickness of 2mm in a zigzag pattern from right to left and from bottom to top.



Step 3: Flatten

After 5-10 minutes, the sprayed surface is flattened with a wide spatula or Darby.

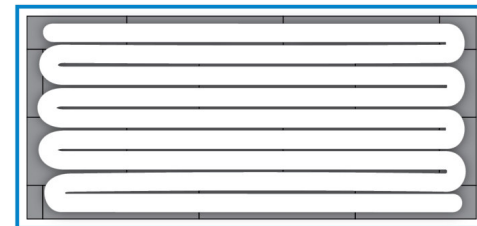

Spray to an even thickness. Apply spray like zigzag pattern from right to left and from bottom to top.



Step 4: Trowel

Use the trowel to flatten the surface.

- a) Right after the final setting, using the sponge to extract gypsum seriflux out of the plaster, spray some water for the extraction if necessary.
- b) Leave to harden, the final trowel is done at around 110 minutes with steel trowel to get a brilliant and hard glazed surface. The wall/ceiling is now finished. Once dry, the surface is ready for decorating with no need for any sanding or additional treatment.

ProPlaster™ Finish Coat is used as the final layer for the smooth finish on Base Coat. One bag of Finish Coat will cover 600sq ft. on Base Coat; for the extra smooth surface a thin layer of Finish Coat can also be applied on One Coat.

***Note Well:** Plastering machine and the application tools should be cleaned after finishing the job.

PRODUCT SPECIFICATIONS:

APPEARANCE:	White Powder
WORKABILITY:	Final setting time before last trowel is 80 minutes
WATER RATIO:	Aprox 15 Ltr in a bag of 30 kgs
COMPRESSIVE STRENGTH:	Greater than 10.5 MN/m ² or 1525 psi (pure plaster).
DENSITY:	1000 kg/m ³
COVERAGE:	30 – 35 sq/ft bag of 30 kgs
THERMAL CONDUCTIVITY:	0.22W/m.K (i.e. gypsum plaster's insulation is about five times better than cement - sand plaster).
SHELF LIFE:	6 months for unopened bag left in dry condition.
PACKAGING:	In 30 Paper bags.

STORAGE CONDITIONS:

- Bags should be store in dry places and should not be stacked in more than 15 layers. Direct contact with ground and moisture must be avoided.
- Using ProPlaster within 6 months after the date of production is recommended.
- Poor or over-long storage may deteriorate the physical properties of ProPlaster



GYPSUM PLASTER VERSUS TRADITIONAL PLASTER, WHICH ONE TO CHOOSE?

Finishing concrete wall applied with conventional sand-cement plastering compared with an application of ProPlaster™



COMPARATIVE CHARACTERISTICS	CONVENTIONAL SAND- CEMENT	PROPLASTER™ HAND/ SPRAY
Time	Highly time consuming due to labor-intensive work.	It is set to save substantial time, and manpower
Wall Surface After Application	Rough texture due to sand aggregate	Perfectly Smooth and fine texture
Pre Application Requirements	Surface needs to be water-sprayed prior to sand-cement application, so that it absorbs the water .This is an essential requirement for applying sand-cement	Slight dampening of surface is required in high temperature areas
Working Preparation	<ul style="list-style-type: none"> • Non-standard mixing ratio of cement aggregates and water. • Work expertise needed • Requires larger working space. 	<ul style="list-style-type: none"> • Installer applies standard mixing ratio, without aggregates. • Easy to work with • Working space is minimal.
Application	15-20mm thickness of coat	10mm ~13mm thickness of coat and only 5mm thickness when apply on pre-fabricated concrete walls/slabs
Crack-resistant	<ul style="list-style-type: none"> • Concrete shrinkage leading to cracks • Either additive or wire net must be applied to improve its cohesion. 	Crack- resistant, shrink-resistant, as gypsum does not shrink or expand once settled
Aesthetic	Inferior due to its roughness and dark color.	Superior with its natural whiteness on smooth surface.
Thermal Conductivity	High due to its cement content.	Very low due to thermal insulation property of gypsum
Speed	28 days to dry and cure	Requires 2 hours only to cure and set. Dry within 24 hours.
Coverage		<ul style="list-style-type: none"> • 2x higher coverage • ½ as much mixing for given area • ½ as much weight to carry • < 5x higher productivity

PROPLASTER™

MP25 MIXING PUMP:

The MP25 Mixit mixer pump is a true all-rounder among mixing pumps. It is suitable for all pumpable ready-mixed dry mortar, whether from a bag or from a silo, for example interior plaster (gypsum/gypsum-lime plaster), external rendering (lime/lime cement and insulating plaster), self leveling floor screed, cementitious adhesive and reinforcement mortar. Different pump parts and versions can vary your mixing and pumping performance of about 5-80 l/min.

Equipment features:

- Powerful electric motor
- Large storage hopper
- Conical mixing tube
- Integrated water pump
- Compressor with pressure switch-off
- Compressed air remote control
- Can be dismantled into practically sized assemblies
- Easily accessible flow meter for modifying the water quantity

We recommend a supply cable with CEE plug 5 x 2,5 mm², 32 A.

Standard equipment:

V35/V25 reducer, 1x 15 m ND 25/40 mortar hose, 1x ND 25/40 spray gun, 1x 15 m air hose, cleaning tools, standard tools, operating manual

Technical data:

(MP 25 Mixit)

Model	MP 25 Mixit
Pump Type	Worm pump D6 Power
Drive Pump	400 V 50 Hz
Output	25l / min
Pressure	40bar
Compressor	Air compressor 0.55 kW/ 200 l/ min
Engine	400 V 50 Hz electric motor
Engine Power	5,5kW
Engine Rotations	392UpM
Hopper Volume	115l
Weight	240kg
Dimensions Lxwxh	1324mm x 728mm x 1443mm
Filling Height	984 mm
Max Aggregate	4mm
Pressure Connection	M 35/V25-4



Putzmeister

Equipping you with
TIME SAVING tools

MIXER PUMP MP 25 MIXIT



Made in Germany!



High Performance, Low Cost Mixer Pump now available in Pakistan!

RELIABILITY
SUSTAINABILITY
SMOOTH FINISH
TIME SAVING
SOUND PROOF
EASY APPLICATION
LESS PAINT

want a crack-free wall ?

PROPLASTER™

PROPLASTER™

FINISH COAT



HEAD OFFICE

Suite # 105, Business & Finance Centre,
I.I Chundrigar Road, Karachi, Pakistan.
UAN: +92-21-111-332-497
T: +92-21-3243 4308, 3241 3832, 3246 7890
F: +92-21-3242 3721
E: info@arishdrywall.com

REGIONAL OFFICE

Suite # 519, 5th Floor, Silver Oaks F10,
Islamabad, Pakistan.
Tel: +92 301 873 4684

WWW.ARISHDRYWALL.COM
www.facebook.com/Arishdrywall

A PRODUCT OF
LODHIA
G Y P S U M
ISO 9001 : 2008



PROPLASTERTM

PROPLASTERTM
FINISH COAT

"Arish", ProBoard is the Registered Trademark of Lodhia Gypsum Industries (Pvt) Ltd.
© Lodhia Gypsum Industries - All Rights Reserved